



DTM-20B



DTM-20A

DTM Series Centrifugal Pump

APPLICATION

- Centrifugal pumps with single impeller are able to offer high flow rates, provide smooth, nonpulsating delivery, and regulate the flow rate over a wide range without damaging the pump.
- For the correct functioning of the pump, use clean water, or non-aggressive liquids charged with small solid impurities.
- To be used in flow irrigation system in gardening, agriculture and industrial fittings.

OPERATING CONDITIONS

- Liquid temperature up to 60°C
- Ambient temperature up to 40°C
- Total suction lift up to 9m
- Continuous duty

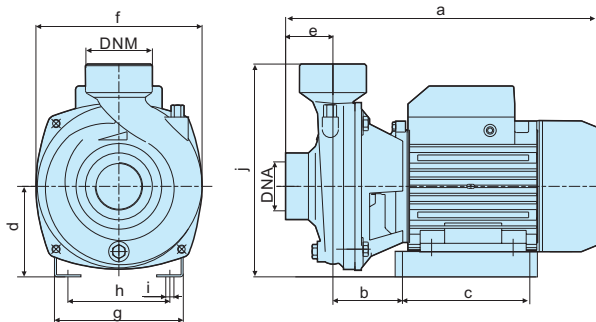

CONSTRUCT

PUMP

Pump Body: Cast Iron
Impeller: Brass / Stainless steel
Mechanical Seal: Carbon / Ceramic / Stainless Steel

MOTOR

Single Phase
Heavy Duty Continuous Work
Motor Housing: Aluminum
Shaft: Carbon Steel / Stainless Steel
Insulation: Class B / Class F
Protection: IP44 / IP54
Cooling: External Ventilation

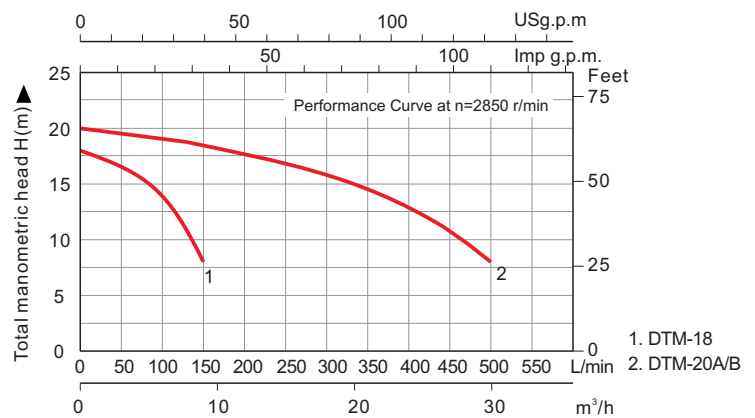

TECHNICAL DATA (220~240V/50Hz)

Model	Single-phase Motor			n=2850r/min				Q																									
	Input max kW	Output Power kW	Current HP	Q.max L/min	H.max m	Suct.max m	US g.p.m		Imp g.p.m	m³/h	L/min	H meter	0	5.28	10.6	15.9	21.1	23.78	26.4	29.1	39.6	48	79	106	132								
DTM-18	1.10	0.75	1.00	5.2	230	18	9	0	4.4	8.8	13.2	17.6	19.8	22	24.2	33	40	66	88	110	18	17.5	17	16.5	15.5	14.8	14	13	8				
DTM-20A	2.00	1.50	2.00	9.6	500	20		0	1.2	2.4	3.6	4.8	5.4	6	6.6	9	11	18	24	30	20	19.9	19.9	19.8	19.8	19.5	19.3	19	18.5	18	16	13	8
DTM-20B	2.00	1.50	2.00	9.6	500	20		0	1.2	2.4	3.6	4.8	5.4	6	6.6	9	11	18	24	30	20	19.9	19.9	19.8	19.8	19.5	19.3	19	18.5	18	16	13	8

Other voltages and frequencies available on request.

OVERALL & INSTALLATION DIMENSIONS

Model	DIMENSIONS (mm)															PACKAGE DIMENSIONS & G.W.					
	DNA		DNM		a	b	c	d	e	f	g	h	i	j	k	l	m	A	B	H	kg
DTM-18	1.5"	40	1.5"	40	320	133	145	100	54	190	131	100	8	244	--	--	--	355	210	270	18.0
DTM-20A	2"	50	2"	50	365	135	160	104	50	208	160	130	10	248	--	--	--	390	220	270	22.0
DTM-20B	2"	50	2"	50	388	--	--	112	60	207	207	160	10	259	--	--	--	420	220	270	23

