



2DKm-1E  
2DKm-2C

# DKM Series Centrifugal Pump

## APPLICATION

- Centrifugal pumps with single impeller are able to offer high flow rates, provide smooth, nonpulsating delivery, and regulate the flow rate over a wide range without damaging the pump.
- For the correct functioning of the pump, use clean water, or non-aggressive liquids charged with small solid impurities.
- To be used in flow irrigation system in gardening, agriculture and industrial fittings.

## OPERATING CONDITIONS

- Liquid temperature up to 60°C
- Ambient temperature up to 40°C
- Total suction lift up to 9m
- Continuous duty

## CONSTRUCT

### PUMP

Pump Body: Cast Iron  
Impeller: Brass  
Mechanical Seal: Carbon / Ceramic / Stainless Steel

### MOTOR

Single Phase  
Heavy Duty Continuous Work  
Motor Housing: Aluminum / Cast Iron  
Shaft: Carbon Steel / Stainless Steel  
Insulation: Class B / Class F  
Protection: IP44 / IP54  
Cooling: External Ventilation

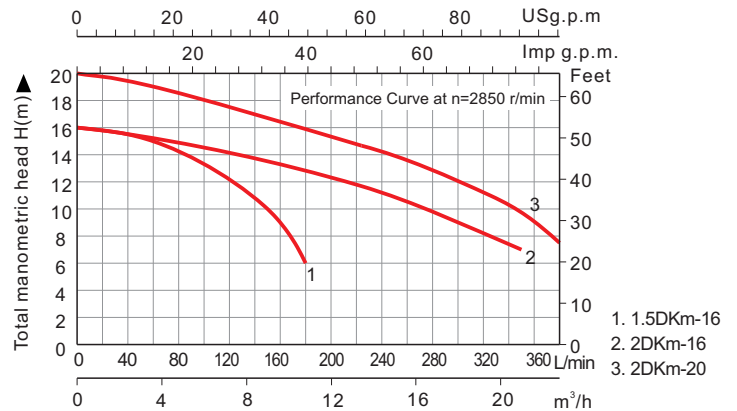
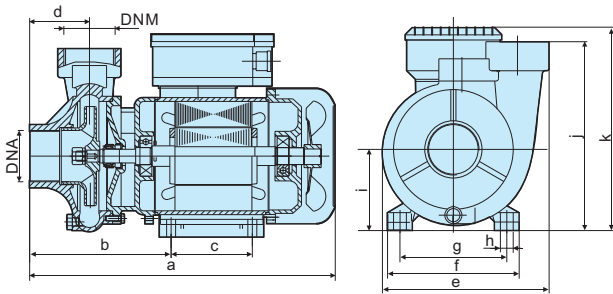

## TECHNICAL DATA (220~240V/50Hz)

Model	Single-phase Motor				n=2850r/min			US g.p.m	Q	Imp g.p.m	m³/h	L/min	H meter													
	Input max kW	Output Power		Current A	Q.max L/min	H.max m	Suct.max m							0	5.28	10.6	15.9	21.1	26.42	31.7	39.6	47.6	66	79	92	100
		kW	HP											0	4.4	8.8	13.2	17.6	22	26.4	33	39.6	55	66	77	83.6
1.5DKm-16	1.10	0.75	1.00	5.2	180	16	9	0	1.2	2.4	3.6	4.8	7.2	9	10.8	15	18	21	22.8							
2DKm-16	1.50	1.10	1.50	7.0	350	16		0	20	40	60	80	100	120	150	180	250	300	350	380						
2DKm-20	2.00	1.50	2.00	9.6	380	20		16	15.8	15.5	15	14	13	12	10	6										
								16	15.8	15.5	15.3	15	14	13.5	13	12.5	11	9	7							
								20	--	19.5	--	18.5	18	17.5	16.3	15.5	14	12	--	7.5						

Other voltages and frequencies available on request.

## OVERALL & INSTALLATION DIMENSIONS

Model	DIMENSIONS (mm)															PACKAGE DIMENSIONS & G.W.				A (mm)	B		
	DNA		DNM		a	b	c	d	e	f	g	h	i	j	k	l	m	A	B			H	kg
	Inch	mm	Inch	mm																			
1.5DKm-16	1.5"	40	1.5"	40	330	155	90	45	190	138	110	10	80	--	199	--	--	360	220	230	16.5		
2DKm-16	2"	50	2"	50	360	162	92	61	185	162	130	10	90	--	207	--	--	380	235	250	23.0		
2DKm-20	2"	50	2"	50	360	162	92	61	185	162	130	10	90	--	207	--	--	380	235	250	26.0		