

CENTRIFUGAL PUMP

CPM Series

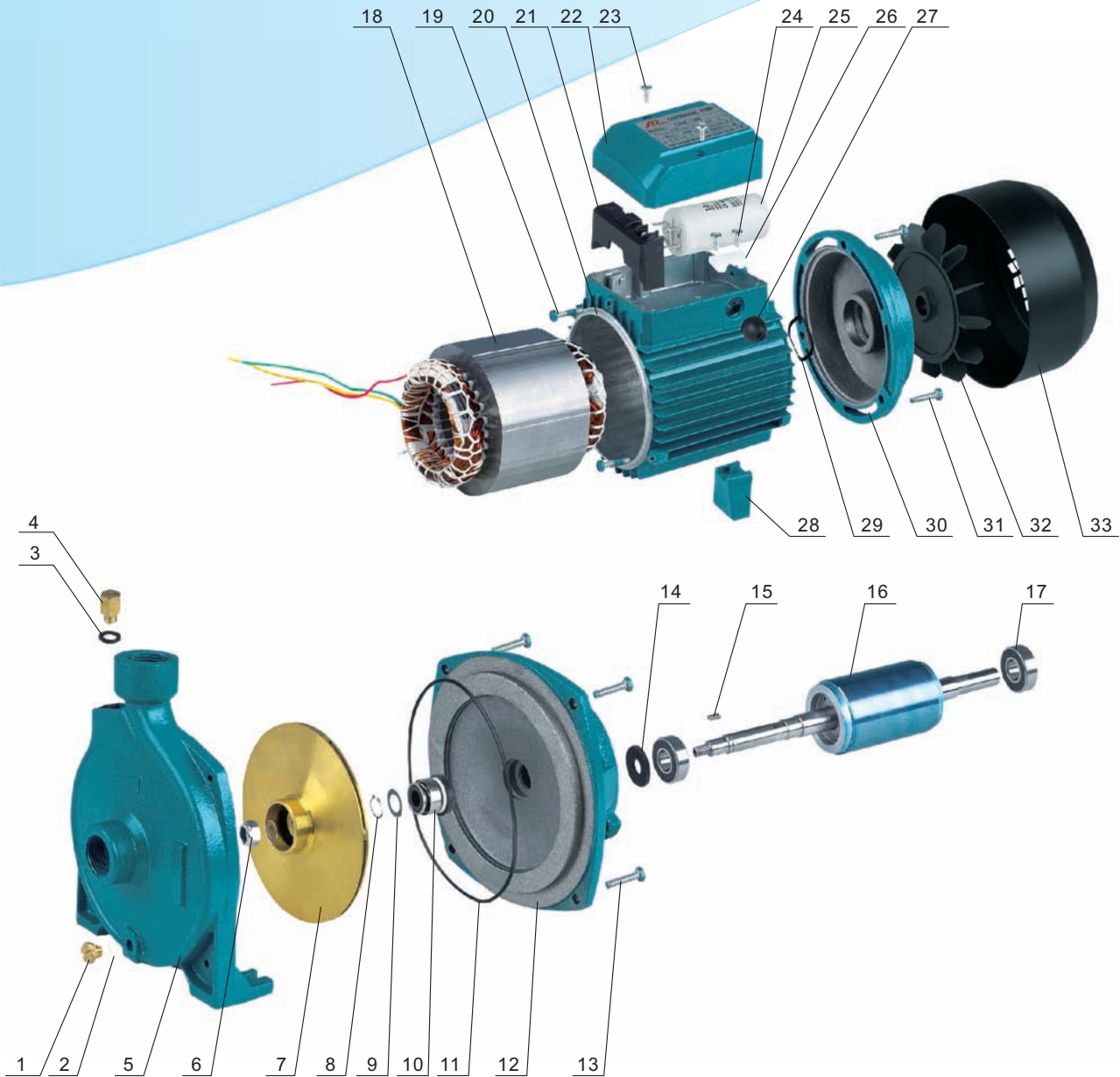

No.	DESCRIPTION	No.	DESCRIPTION	No.	DESCRIPTION
1	Drain Plug	12	Motor Bracket	23	Screw For Terminal Box Fixing
2	"O" Ring For Drain Plug	13	Motor Bracket-pump Body Screw	24	Screw For Cable Presser
3	"O"ring For Filling Plug	14	Splash Guard	25	Capacitor
4	Filling Plug	15	Key	26	Cable Presser
5	Pump Body	16	Shuft And Rotor	27	Water Proof Fairlead
6	Nut For Impeller/impeller Stop Nut	17	Ball Bearing	28	Foot
7	Impeller	18	Stator	29	Adjusting Ring
8	Snap Ring	19	Motor Bracket-motor Case Screw	30	Motor Cover
9	Plain Washer	20	Motor Case	31	Motor Cover-motor Case Screw
10	Mechanical Seal	21	Terminal Board	32	Fan
11	"O" Ring For Pump Body	22	Terminal Cover	33	Fan Cover



CPM-200



CPM-158

CPM Series Centrifugal Pump

APPLICATION

- Centrifugal pumps with single impeller are able to offer high flow rates, provide smooth, nonpulsating delivery, and regulate the flow rate over a wide range without damaging the pump.
- For the correct functioning of the pump, use clean water, or non-aggressive liquids charged with small solid impurities.
- To be used in flow irrigation system in gardening, agriculture and industrial fittings.

OPERATING CONDITIONS

- Liquid temperature up to 60°C
- Ambient temperature up to 40°C
- Total suction lift up to 9m
- Continuous duty

CONSTRUCT

PUMP

Pump Body: Cast Iron
 Impeller: Brass / Stainless steel / Techno-polymer (P.P.O)
 Mechanical Seal: Carbon / Ceramic / Stainless Steel

MOTOR

Single Phase
 Heavy Duty Continuous Work
 Motor Housing: Aluminum
 Shaft: Carbon Steel / Stainless Steel
 Insulation: Class B / Class F
 Protection: IP44 / IP54
 Cooling: External Ventilation

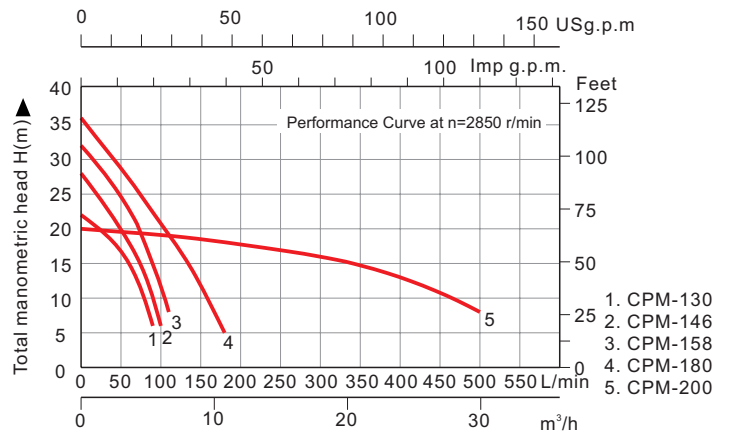
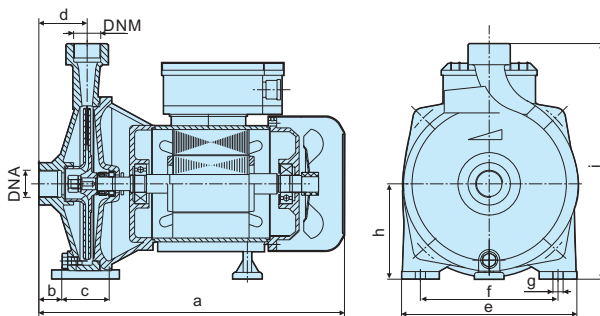

TECHNICAL DATA (220~240V/50Hz)

Model	Single-phase Motor			n=2850r/min			Q	H meter																
	Input max kW	Output Power		Current	Q.max	H.max			Suct.max	US g.p.m	Imp g.p.m	L/min	0	5.28	10.6	15.9	21.1	23.78	26.4	29.1	39.6	48	79	106
		kW	HP	A	L/min	m	m			0	4.4	8.8	13.2	17.6	19.8	22	24.2	33	40	66	88	110		
CPM-130	0.60	0.40	0.56	2.9	90	22	9	H meter	0	1.2	2.4	3.6	4.8	5.4	6	6.6	9	11	18	24	30			
CPM-146	0.75	0.55	0.75	3.8	100	28			0	20	40	60	80	90	100	110	150	180	300	400	500			
CPM-158	1.10	0.75	1.00	5.2	110	32			22	20	18	15	10	6										
CPM-180	1.50	1.10	1.50	7.0	180	36			28	25	22	18	14	10	6									
CPM-200	2.020	1.50	2.00	9.6	500	20			32	30	26.5	23	18	15	12	8								
										36	--	30	27	24	22	20	18.5	12	5					
										20	--	19.9	--	19.8	--	19.3	--	18.5	18	16	13	8		

Other voltages and frequencies available on request.

OVERALL & INSTALLATION DIMENSIONS

Model	DIMENSIONS (mm)																PACKAGE DIMENSIONS & G.W.				
	DNA		DNM		a	b	c	d	e	f	g	h	i	j	k	l	m	A	B	H	kg
	Inch	mm	Inch	mm																	
CPM-130	1"	25	1"	25	295	--	--	42	170	135	10	82	211	--	--	--	--	310	170	230	8.9
CPM-146	1"	25	1"	25	305	--	--	44	190	160	10	100	242	--	--	--	--	340	210	260	12.2
CPM-158	1"	25	1"	25	305	--	--	44	190	160	10	100	242	--	--	--	--	340	210	260	13.8
CPM-180	1.5"	40	1.5"	40	360	--	--	53	207	160	10	112	262	--	--	--	--	400	220	280	21
CPM-200	2"	50	2"	50	388	32	--	60	207	160	10	112	259	--	--	--	--	420	220	270	23

